

**GENERAL PURPOSE TRANSISTOR**

- \*Complement to S8550LT1
- \*Collector Current :Ic= 500mA
- \*Collector Dissipation: Pc=225mW

**ABSOLUTE MAXIMUM RATINGS (Ta=25°C unless otherwise specified)**

Characteristic	Symbol	Rating	Unit
Collector-Base Voltage	Vcbo	40	V
Collector-Emitter Voltage	Vceo	25	V
Emitter-Base Voltage	Vebo	6	V
Collector Current	Ic	500	mA
Collector Dissipation Ta=25°C*	Pc	225	mW
Junction Temperature	Tj	-55-150	°C
Storage Temperature	Tstg	-55-150	°C

Package:SOT-23



STYLE	PIN:	1	2	3
	NO.1	B	E	C

**ELECTRICAL CHARACTERISTICS(Ta=25°C unless otherwise specified)**

Characteristic	Symbol	Min	Typ	Max	Unit	Test Conditions
Collector-Base Breakdown Voltage	BVcbo	40			V	Ic=100uA Ie=0
Collector-Emitter Breakdown Voltage#	BVceo	25			V	Ic= 1mA Ib=0
Emitter-Base Breakdown Voltage	BVebo	6			V	Ie= 100uA Ic=0
Emitter-Base Cutoff Current	Icbo			100	nA	Vcb=40V Ie=0
Emitter-Base Cutoff Current	Iebo			100	nA	Veb= 6V Ic=0
DC Current Gain	Hfe	200		350		Vce= 1V Ic= 50mA
Collector-Emitter Saturation Voltage	Vce(sat)			0.6	V	Ic= 500mA Ib=50mA
Base-Emitter Saturation Voltage	Vbe(sat)			1.2	V	Ic= 500mA Ib=50mA
Base-Emitter On Voltage	Vbe(on)			1	v	Vce= 1V Ic= 10mA
Output Capacitance	Cob		9		PF	Vcb=10V Ie=0 f=1MHz
Current Gain-Bandwidth Product	fT	100			MHz	Vce= 10V Ic= 50mA f=30MHz

\* **Total Device Dissipation** :FR=1x0.75x0.062in Board,Derate 25°C.

#**Pulse Test** : Pulse Width ≤300uS,Duty cycle ≤2%

DEVICE MARKING: S8050= J3Y

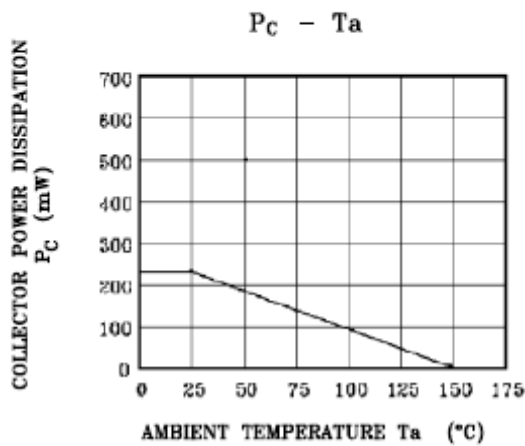
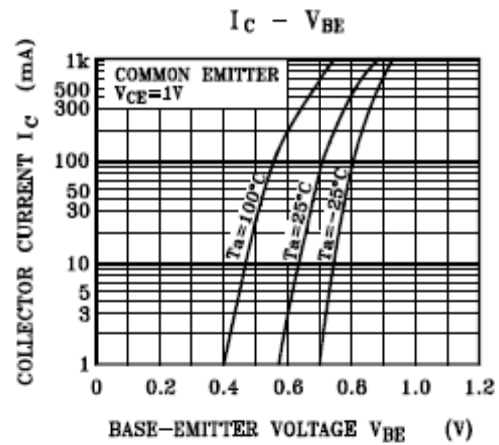
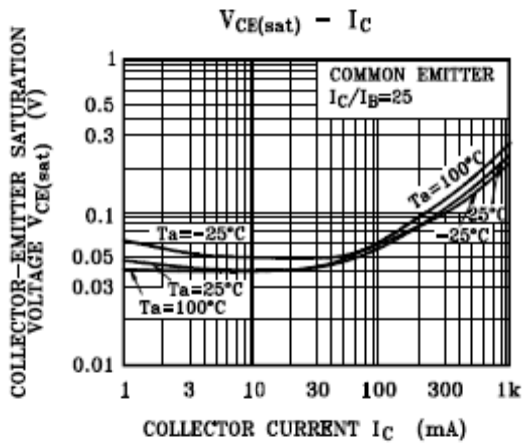
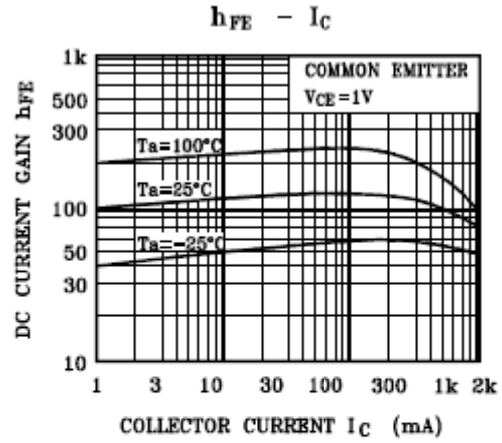
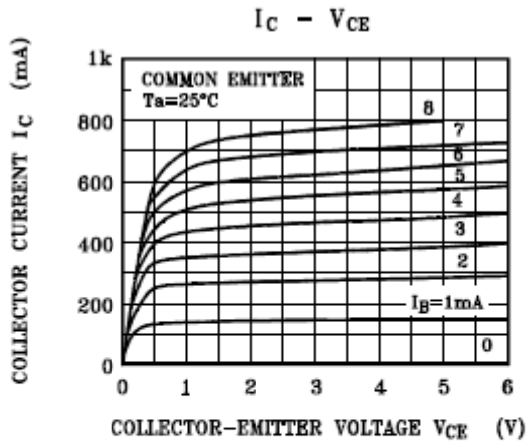

外型尺寸及内部结构图

OUTSIDE DEMENSION AND INTERNAL CONFIGURATION (SOT-23)

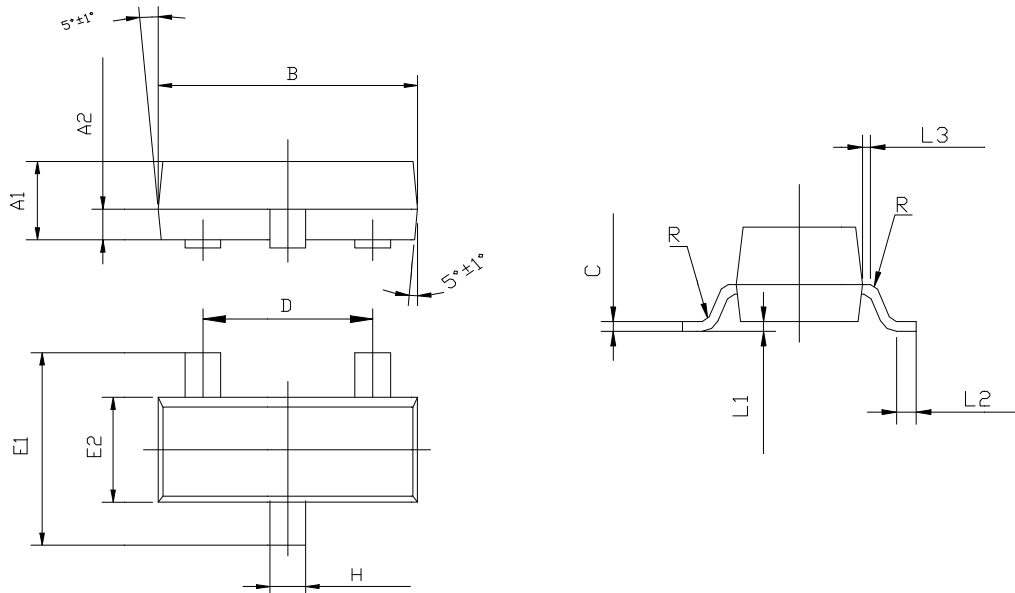

Symbol	Dimensions in Millimeters			内部结构 STYLS	管脚PIN		
	Min	Nominal	Max		1脚	2脚	3脚
A1	0.900	0.970	1.000	6	基极 BASE	发射极 EMITTER	集电极 COLLECTOR
A2	0.350	0.380	0.410				
B	2.800	2.900	3.000	8	阳极 ANODE	不连接NO- CONNECTION	阴极 CATHODE
C	0.085	0.100	0.150				
D	1.800	1.900	2.000	9	阳极 ANODE	阳极 ANODE	阴极 CATHODE
E1	2.200	2.400	2.600				
E2	1.200	1.300	1.400	11	阳极 ANODE	阴极 CATHODE	阳极-阴极 ANODE-CATHODE
H	0.300	0.400	0.500				
L1	0.000		0.100	12	阴极 CATHODE	阴极 CATHODE	阳极 ANODE
L2	0.200						
L3	0.030	0.080	0.130	18	不连接NO- CONNECTION	阴极 CATHODE	阳极 ANODE
R	0.080TYP						
				19	阴极 CATHODE	阳极 ANODE	阴极-阳极 CATHODE-ANODE



OUTSIDE

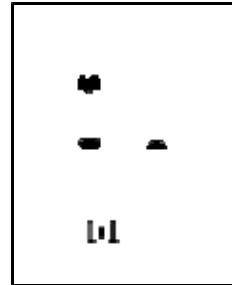

Scale 1:1 on letter size paper

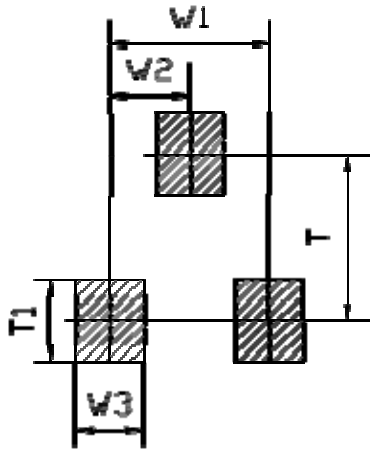

FOOTPRINTS FOR SOLDERING

Symbol	Dimensions in Millimeters	Dimensions in Inches
	Nominal	Nominal
W1	1.900	0.0748
W2	0.950	0.0374
W3	0.800	0.0315
T	2.000	0.0787
T1	1.000	0.0394